

# SCOPE OF WORK

## First Step Head Start

### Modify Play Areas

#### Upper Play Area

1. All work is to be prevailing wages.
2. Removals
  - a. Excavate grass and dirt until level with walkway.
  - b. Large sandbox with wooden shade structure.
  - c. Remove southwest corner of PIP surface for new sandbox. Must maintain 6 foot fall distance from play structure.
  - d. Excavate dirt between trees for play house.
  - e. Cap irrigation system as required for installations.
3. Install 41' X 36' shade structure over existing play structure. To be metal and fabric materials. This is to be listed as an optional cost.
4. Install sandbox in southwest corner of PIP area under new shade structure. To include "fossils" under the sand for children to find.
5. Install a "pride" rock or similar small climbing structure with fall surface of PIP next to wooden benches and shade area..
6. Install 8 ft. X 8 ft. play house between two trees.
7. Prepare and install artificial turf in two areas that are currently grass, approx. 915 sq. ft.
8. Fabricate and install three garden boxes, approx. 3 ft. wide by 8 ft. long.
9. Install two small bench logs and six "tree stumps" under the shade structure for a reading area.
10. Install 15' X 30' shade structure over artificial turf area as shown.
11. Install the following stand alone play activities(2006 catalog):
  - a. Number sequencing panel, pg. 73
  - b. Bell panel, pg. 73
  - c. Drum panel, pg. 73
  - d. Driver panel, pg. 74
12. Post bumper required on supports for the shade structure. Canvas construction, 4 feet in height.

## **Lower Play Area**

1. Install artificial turf at north end of playground, approx. 20 ft. X 20ft. Prep surface as required.
2. Install 20 ft. X 20 ft. shade structure over artificial turf.
3. Install 10 ft. X 10 ft. shade structure over existing sandbox.
4. Install concrete bike path around sandbox.
5. Post bumpers required on supports for the shade structures. Canvas construction, 4 feet in height.
6. Install the following stand alone play activities(2006 catalog):
  - a. Bell panel, pg. 73
  - b. Drum panel, pg. 73

# FIRST STEP HEAD START

## 804 San Pasqual St.

### Playground Removals

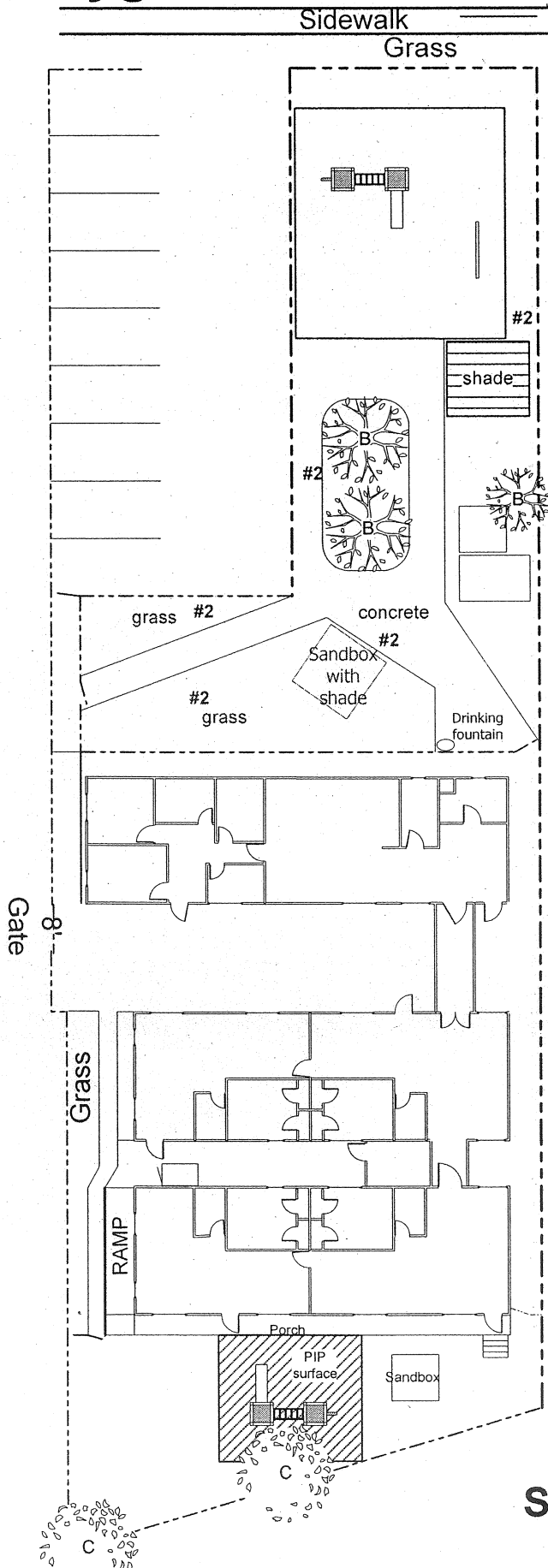

Scale: .035" = 1' 0"

